

Battery breather pipe
Pass it through holes of fitting metals respectively on lower side of battery and on right side of bracket, rear arm (frame complete)

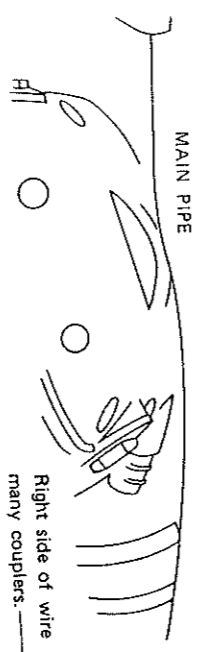

Right side of wire harness with many couplers.

Throttle wire
Pass it under wire harness.

Pass lead wire for ground under main pipe.

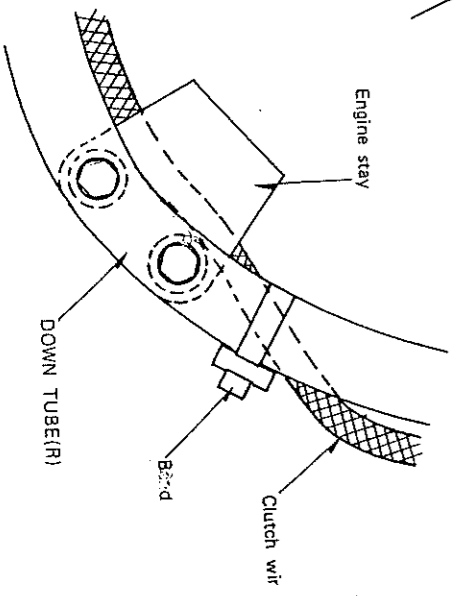
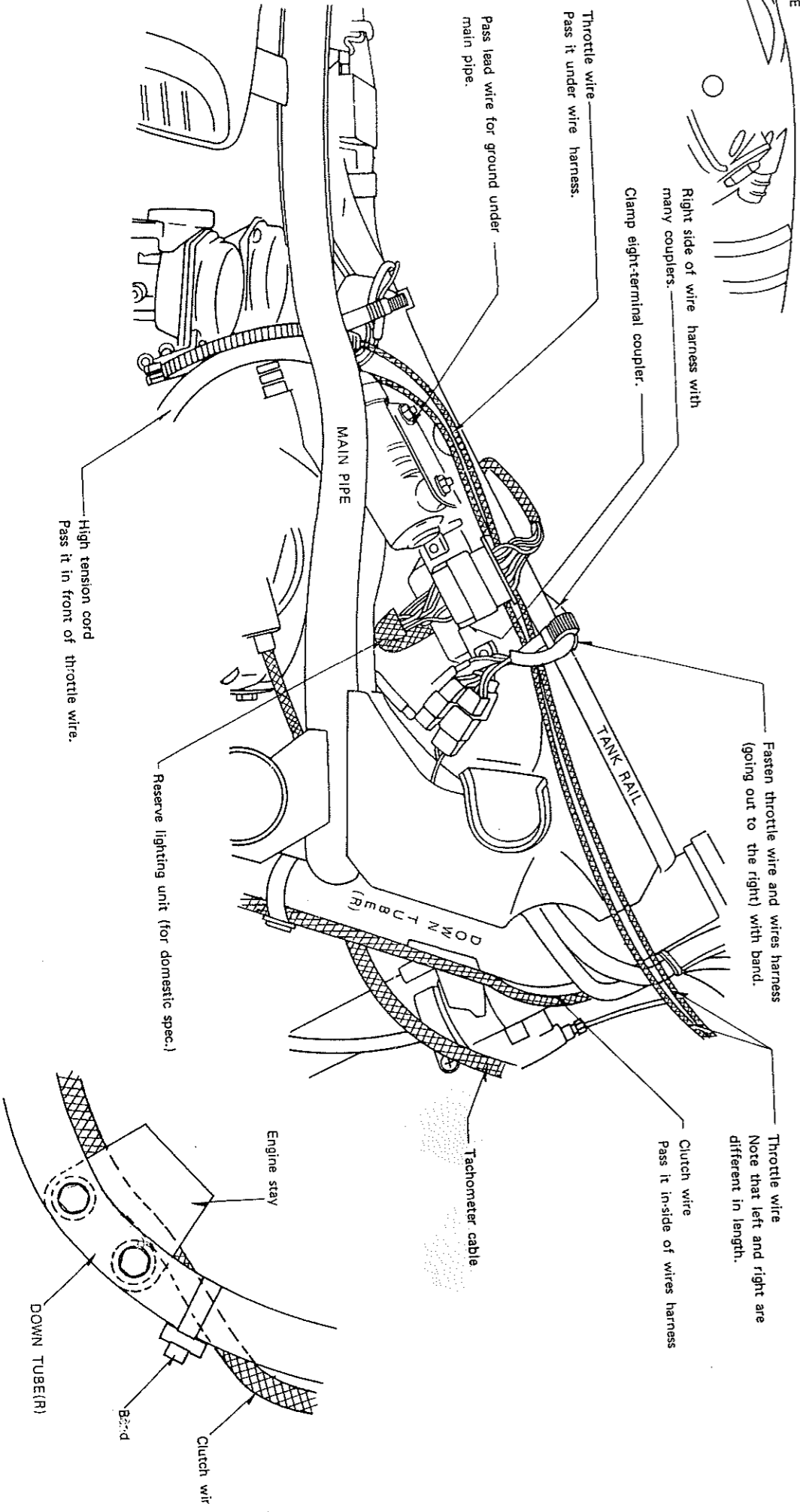

Clamp.

ELECTRICAL CIRC

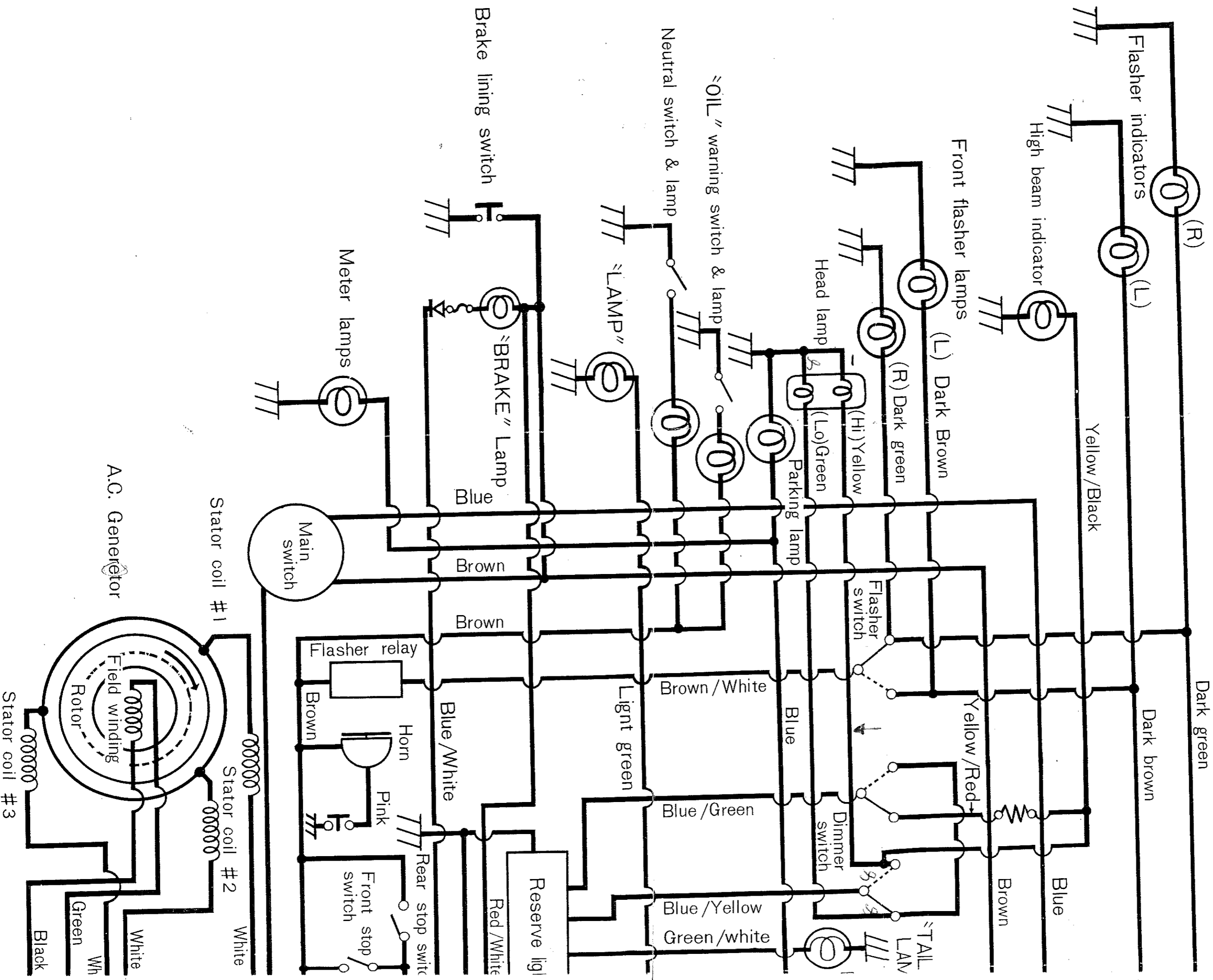

JIT DIAGRAM

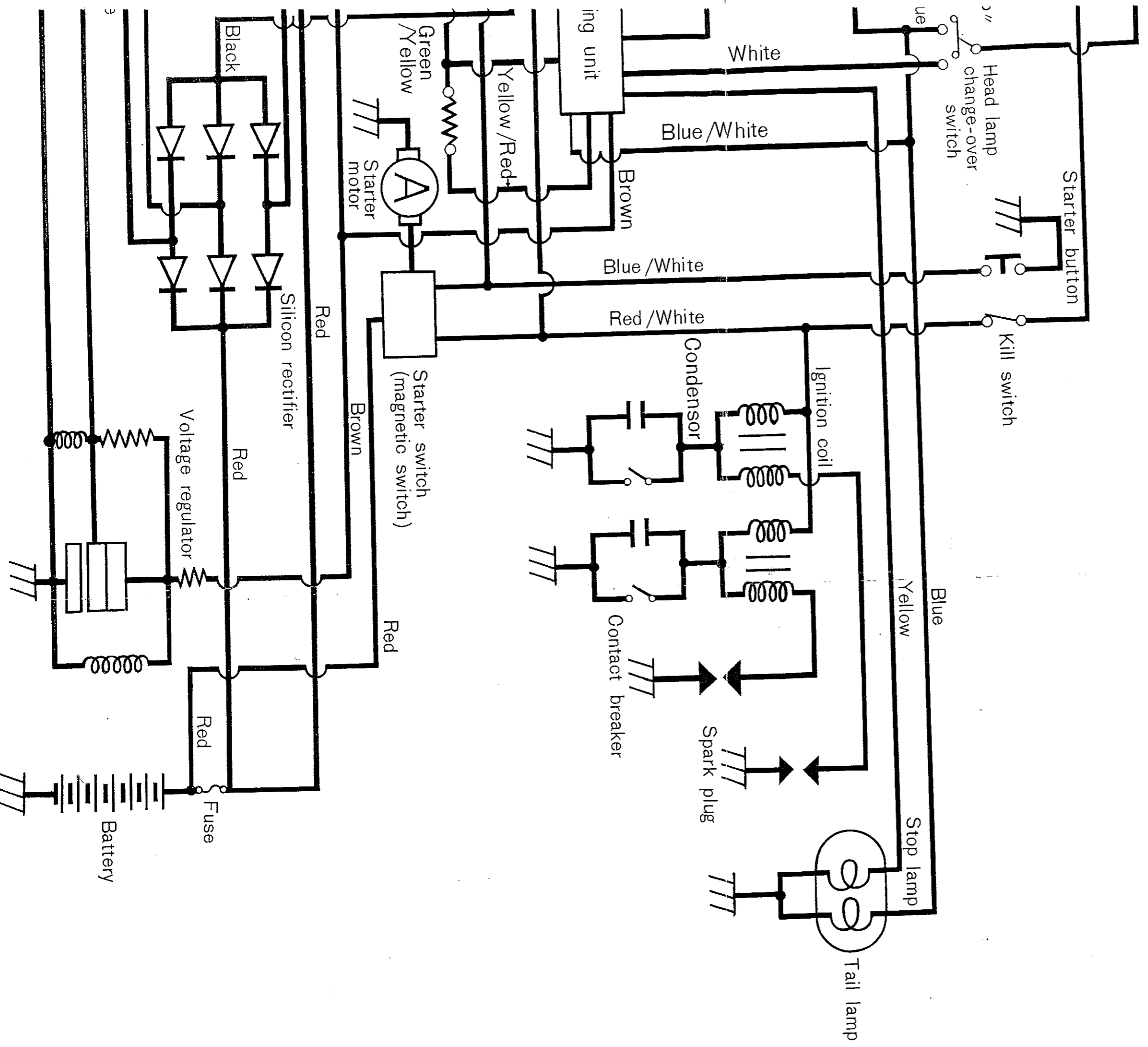
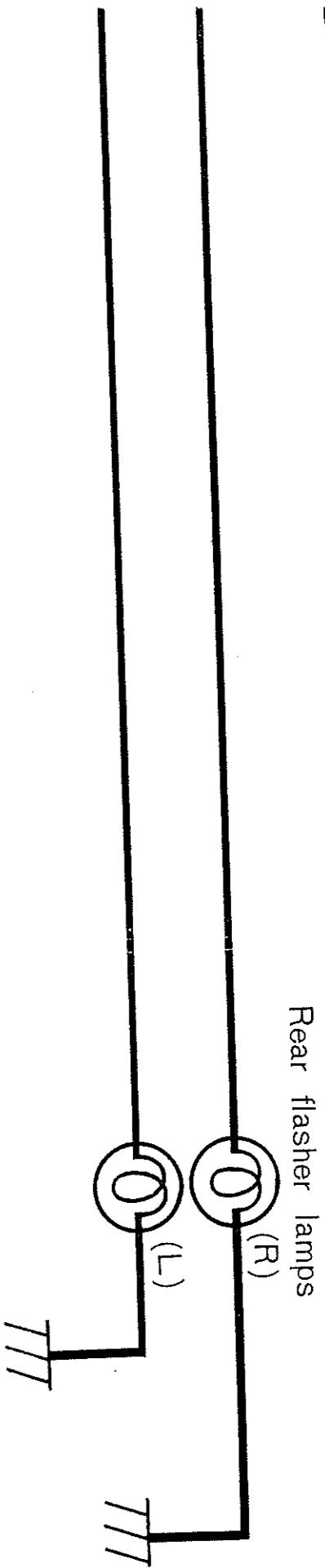

CABLE R

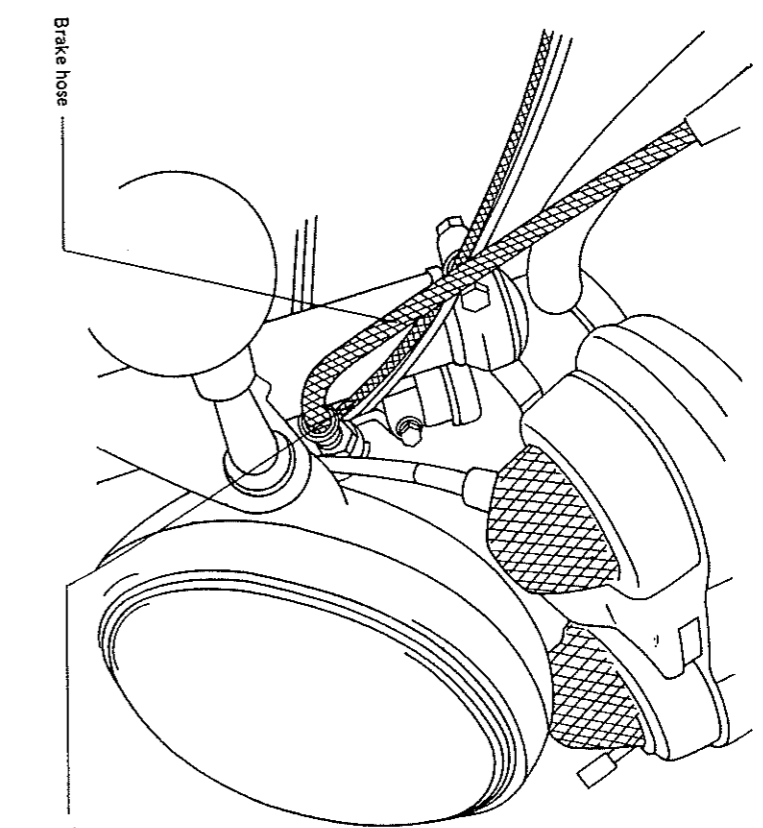

Throttle wire
Pass it between metal holder for brake hose and lamp stay.

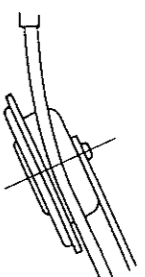

Tachometer cable
Pass it to the right of horn.

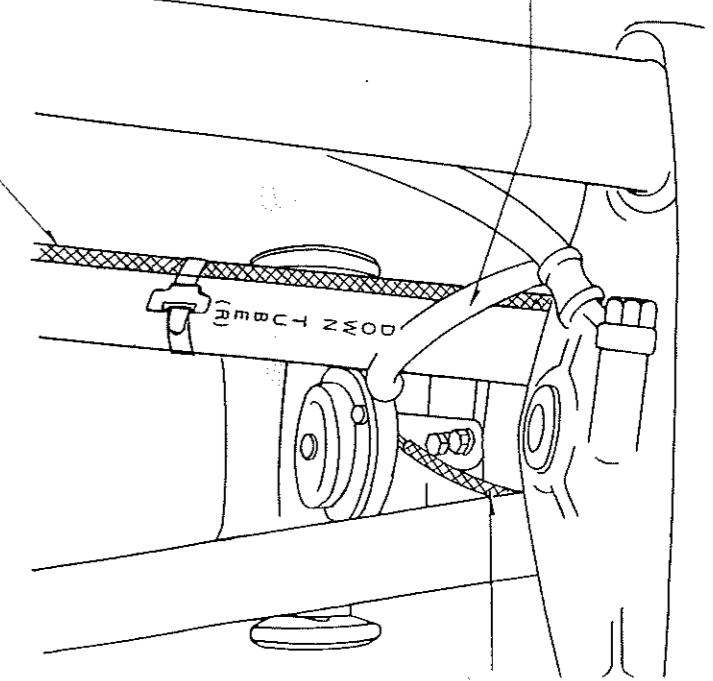

Clutch wire
Fix it with aluminum bands at two positions.

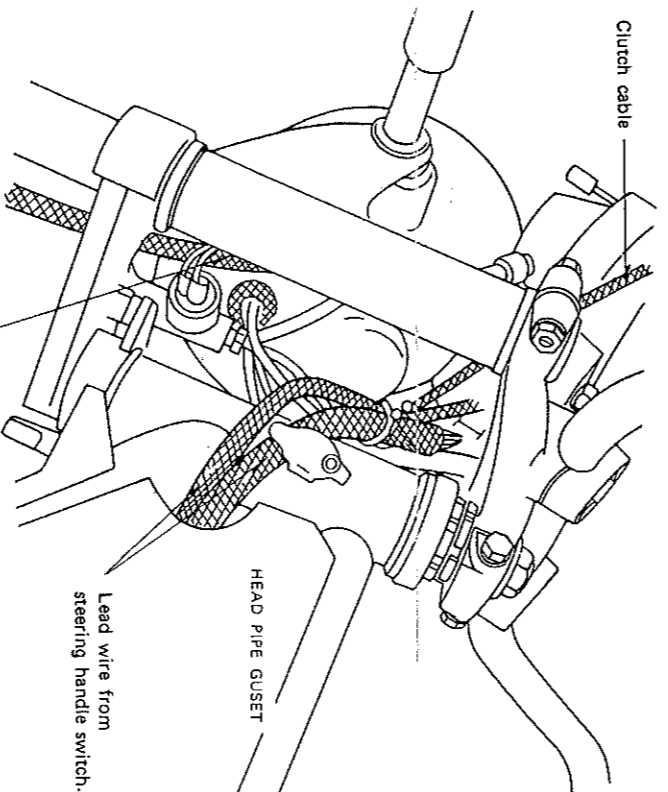

Clutch cable
HEAD PIPE GUSET
Lead wire from steering handle switch.
Fix front stop lead wires to the clamp on inner side of lamp stay.

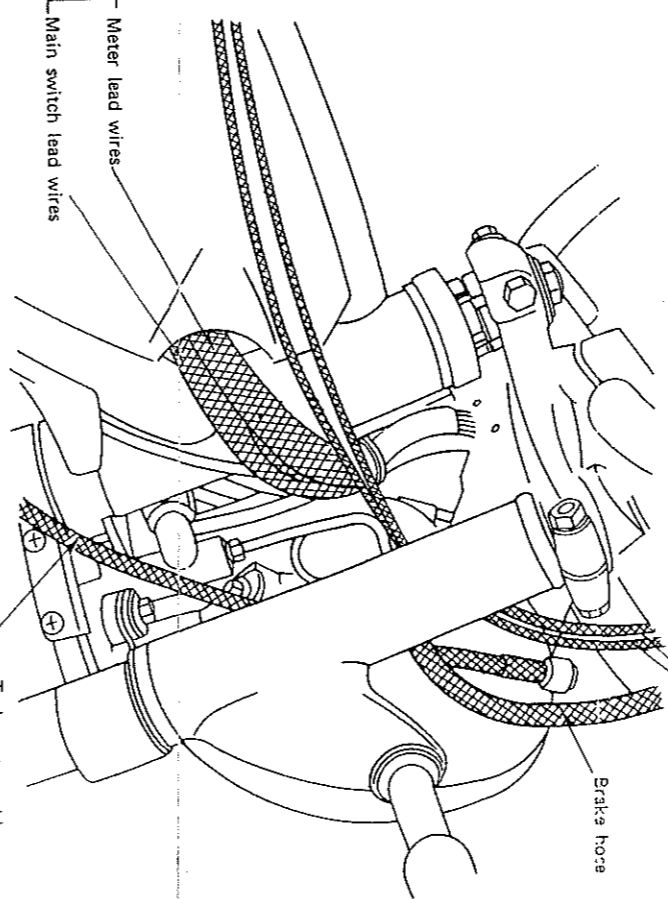

Take meter lead wires and switch lead wires out of right hole.

Meter lead wires
Main switch lead wires

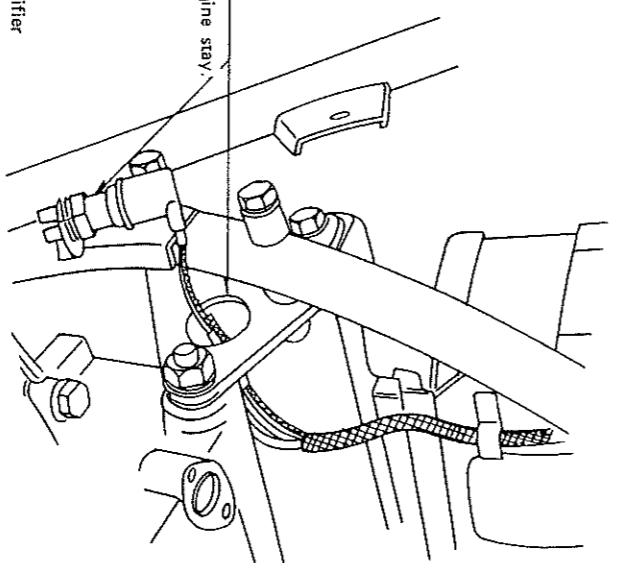

Stop switch lead wire
Take it out of hole in engine stay.

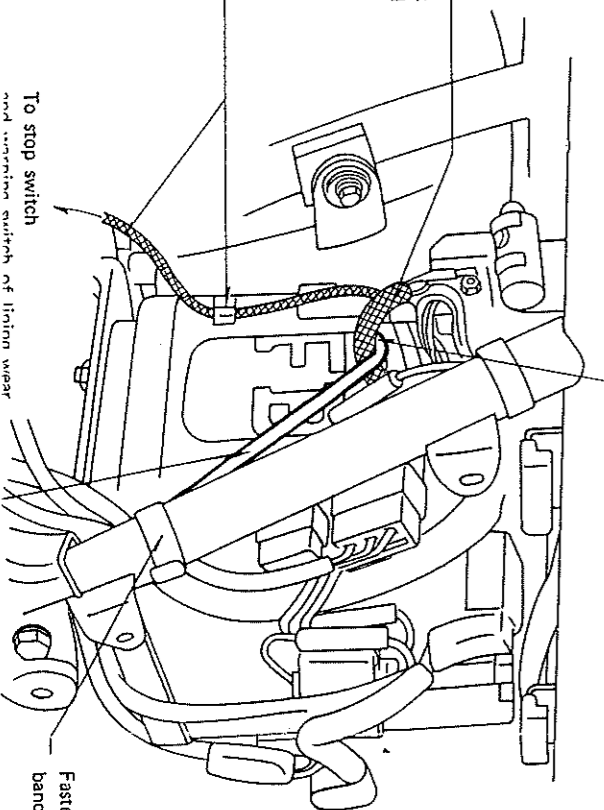

Pass oil tank breather pipe on underside of rectifier lead wires.

Rectifier lead wires
Use upper left clamp of clamps on battery box front to fasten it together with stop switch lead wires.

Fasten lead wires with three clamps on battery box front.

To stop switch and variation switch of ignition wear

Fasten oil tank breather pipe and ACG lead wires with band. Take care not to squash the breather pipe.